

WARNING!

Use this guide at your own risk. Its' author, provider, and affiliates assume no responsibility as a result of its use.

This document is meant to serve as a guide in detail stripping your Polish P64 pistol. It's not intended to be used as an Owner's Manual or for routine maintenance.

This guide can be used in tandem with the P64 Parts List document, which can be found here:

[http://www.p64resource.com/board/P64 Parts List.pdf](http://www.p64resource.com/board/P64_Parts_List.pdf)

Remember, safety first! Check that your firearm is unloaded, then check it again!

If you have any questions about this document, please visit the forum to start a topic: <http://www.p64resource.com/forum>



P-64 Assembly/Disassembly

You just need some common tools to do this. For disassembly use this as guide to remove the parts in a convenient order.



Step 1



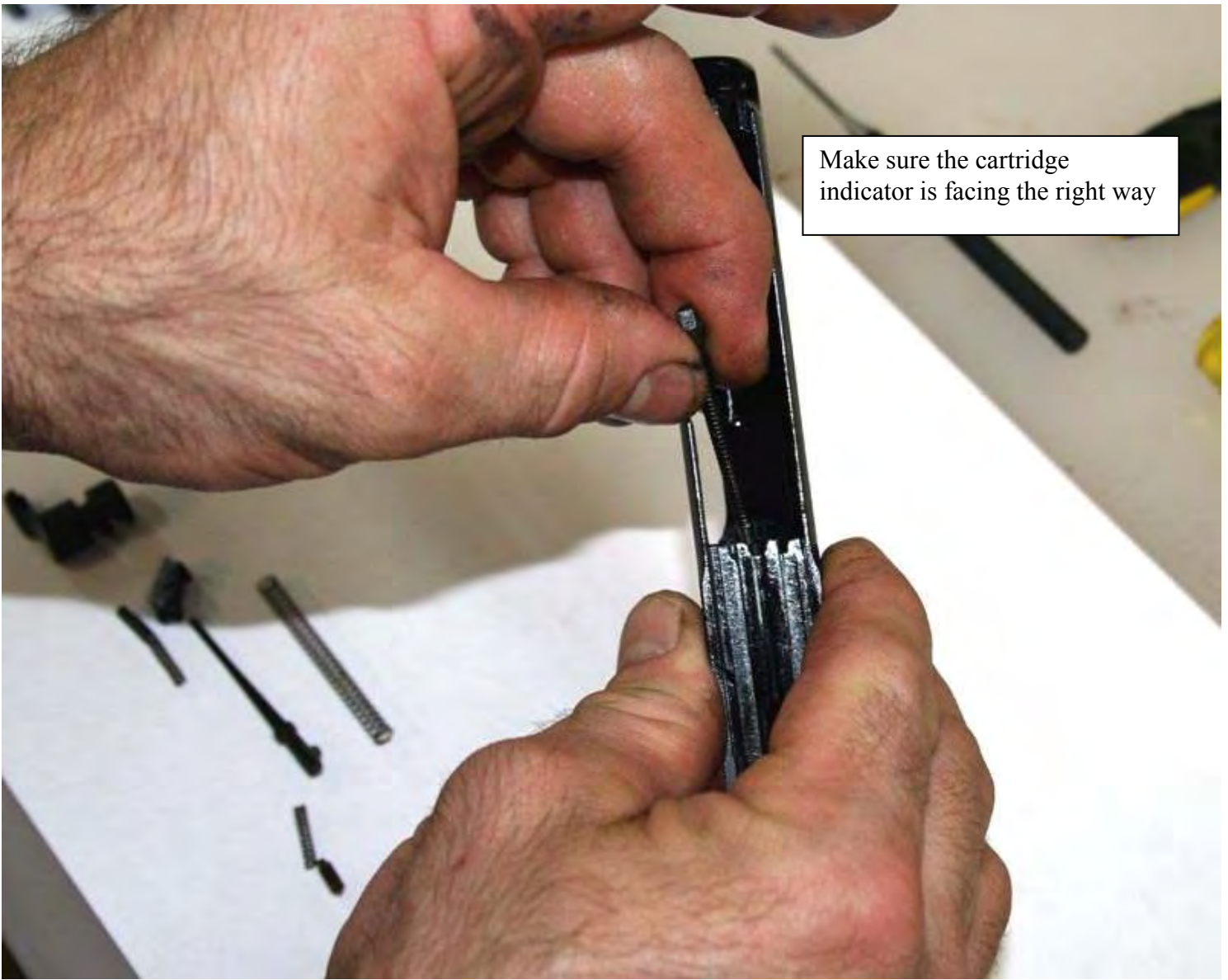

Make sure the cartridge indicator is facing the right way

Push in with the left finger while capturing the cartridge indicator with the lock between the spring and guide rod. See below photo.

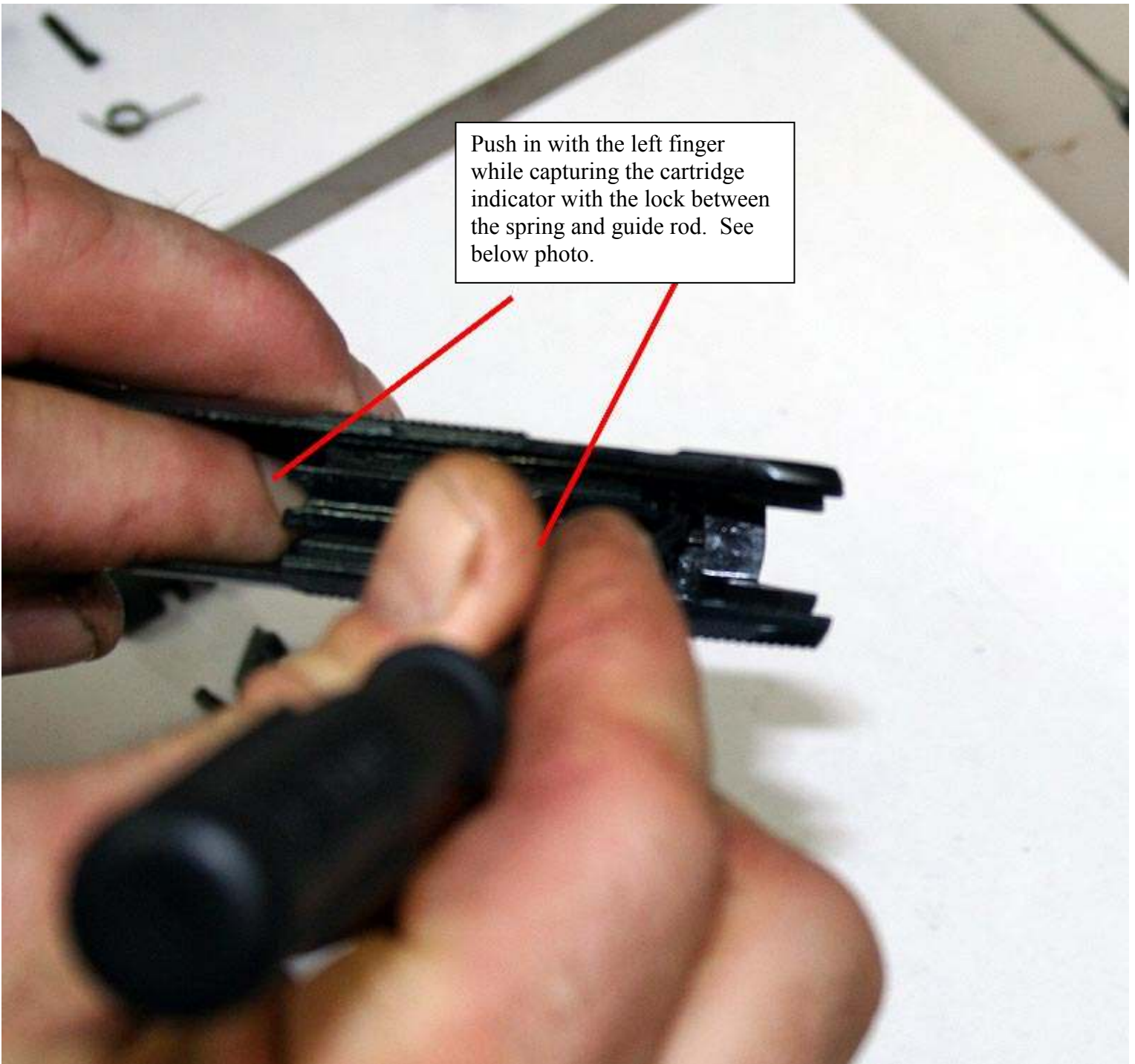

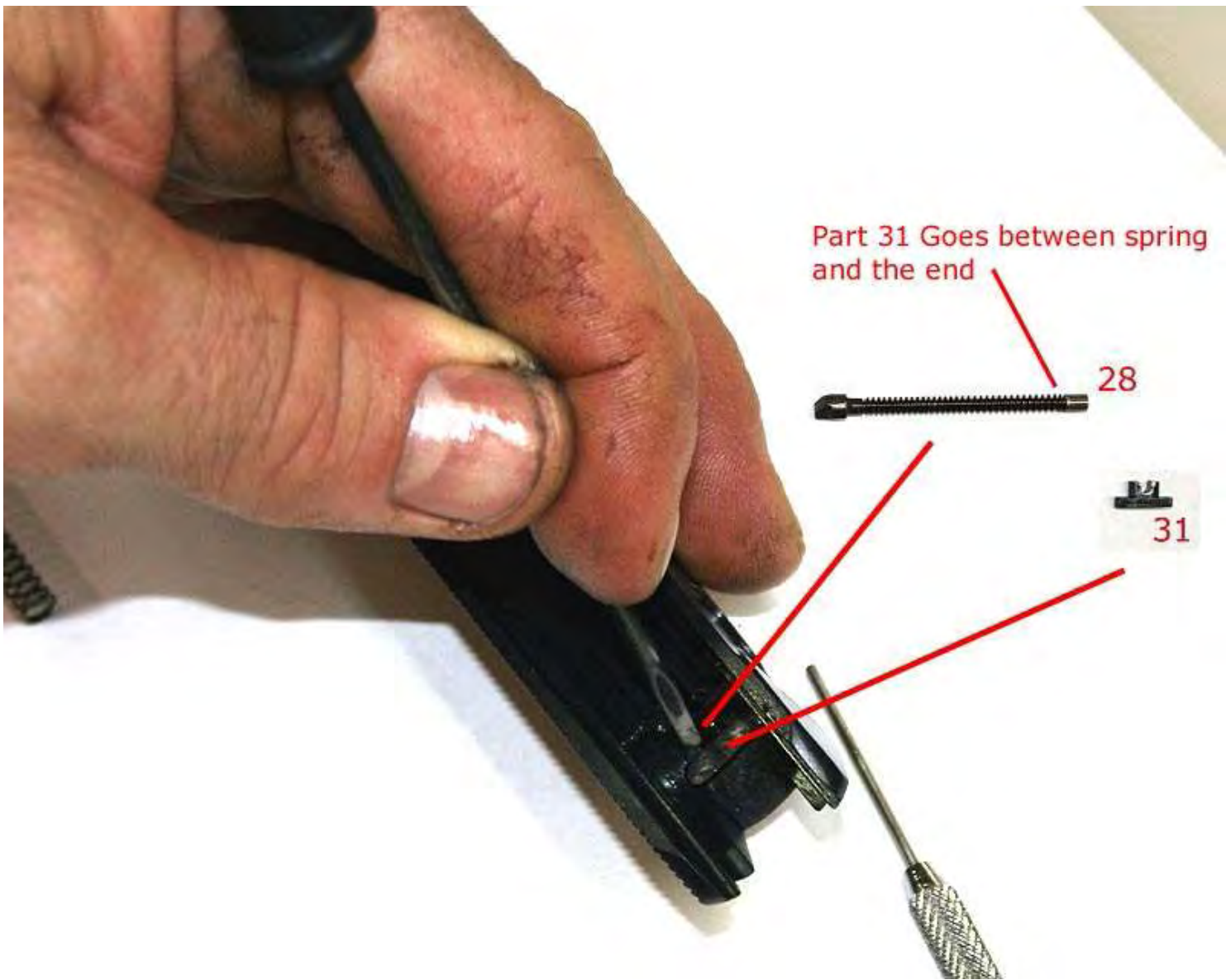

Part 31 Goes between spring and the end

28

31



This is how it should look



Step 2

Part 29 & 30



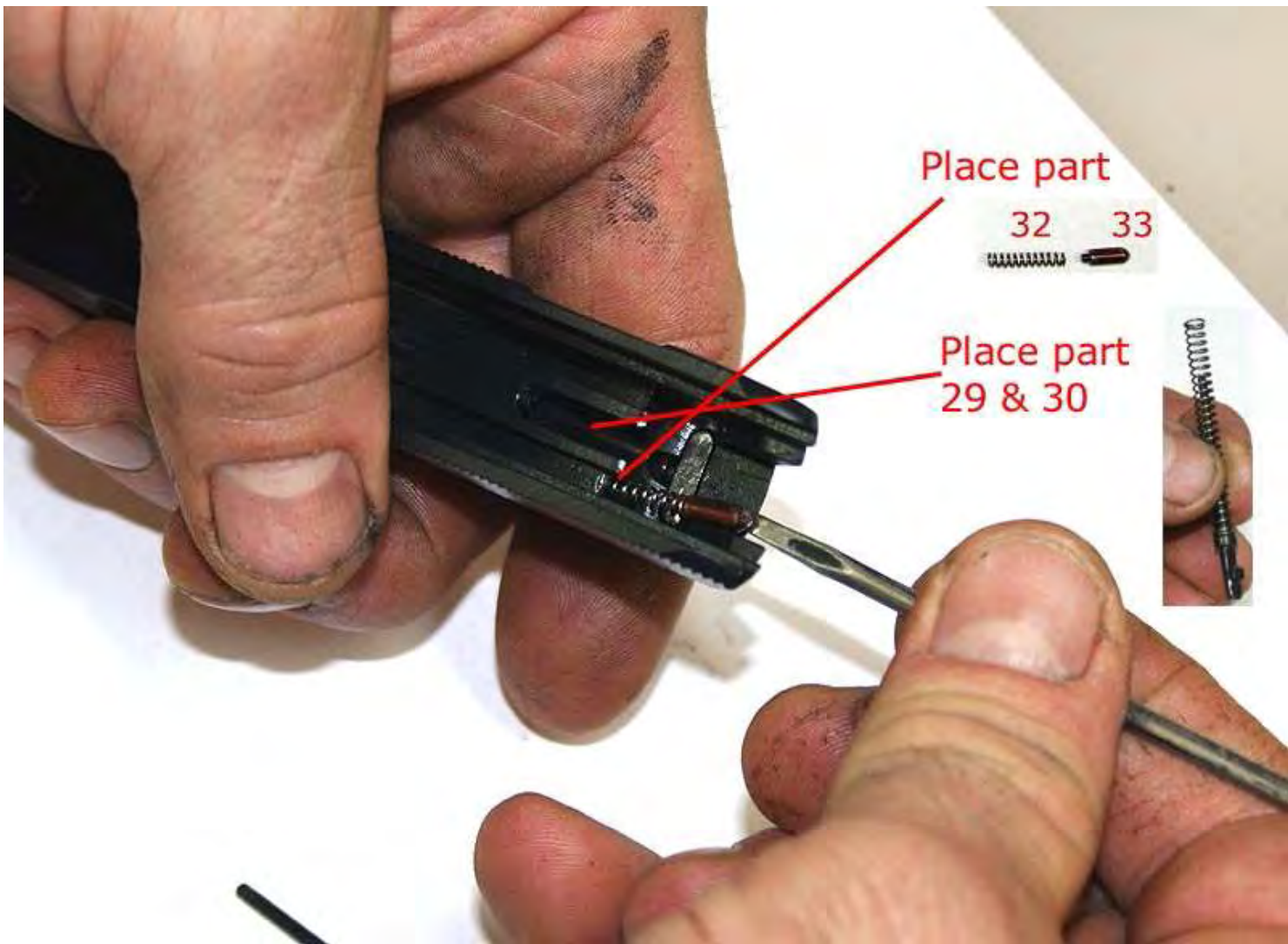

Place part

32 33

Place part
29 & 30





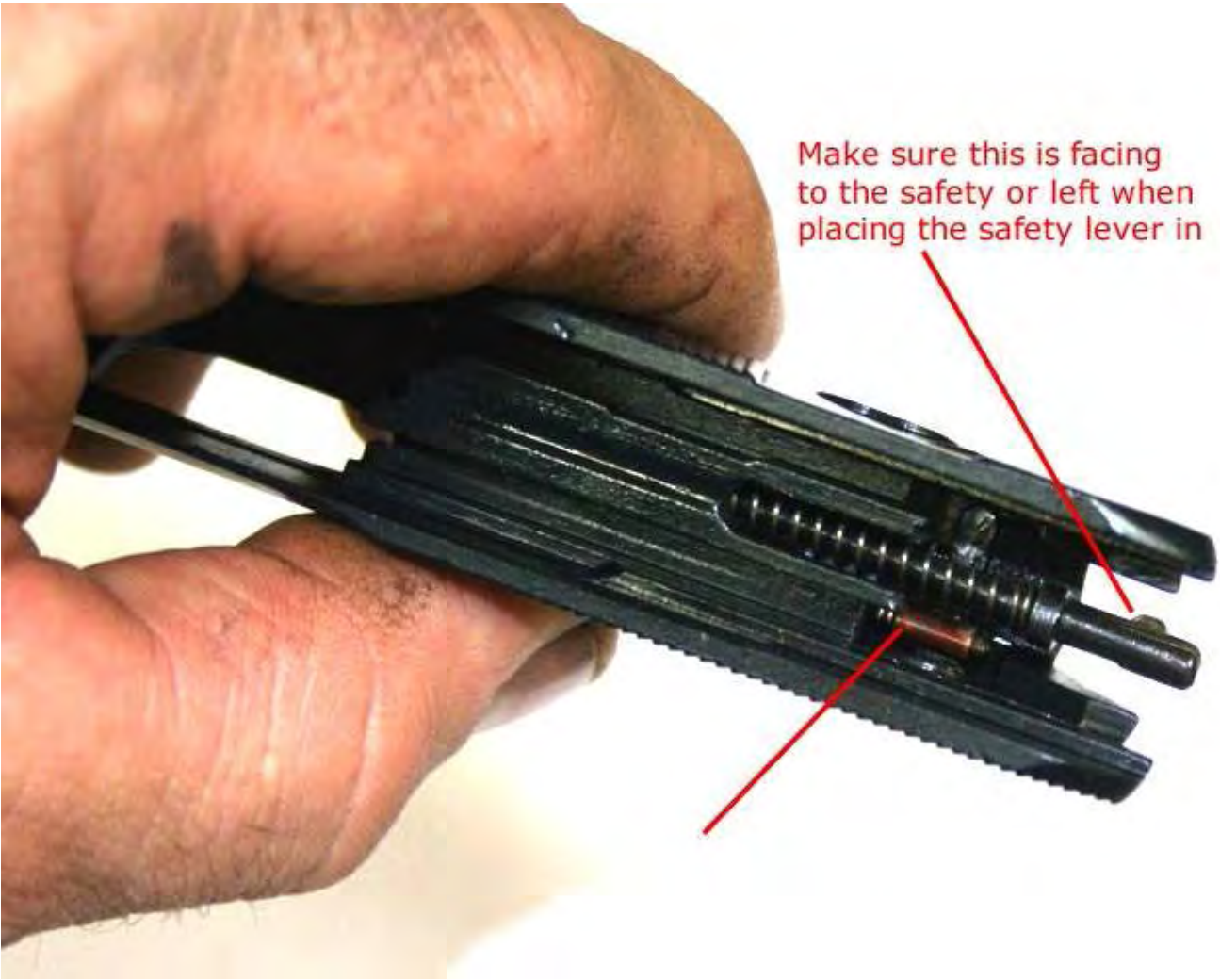

Make sure this is facing to the safety or left when placing the safety lever in

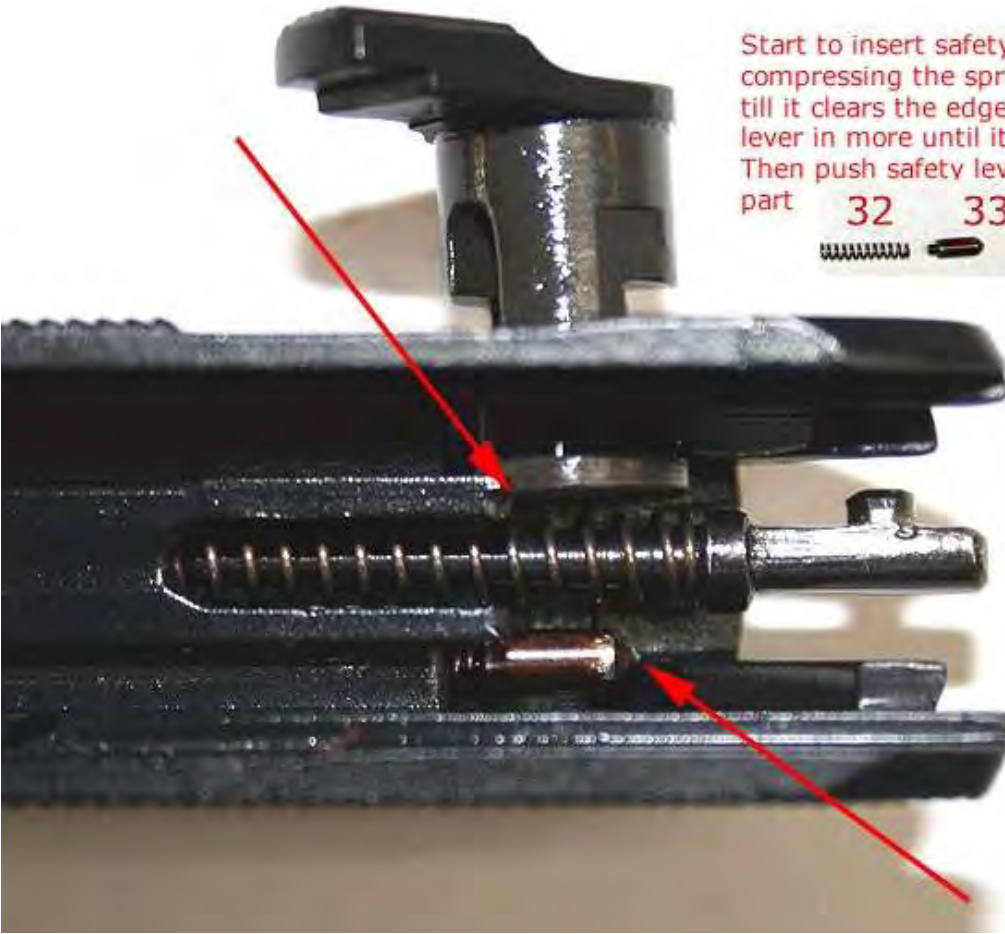

Start to insert safety while pushing firing pin and compressing the spring into recessed hole in slide till it clears the edge of the inserted safety. Push safety lever in more until it captures the end of the firing pin. Then push safety lever in more till it rests against



part 32 33 Then compress part 33 in until you can push safety lever all of the way in. The safety lever will try and angle so you will need to use a screwdriver and keep the alignment straight as you finish inserting the lever meanwhile keeping part 33 compressed

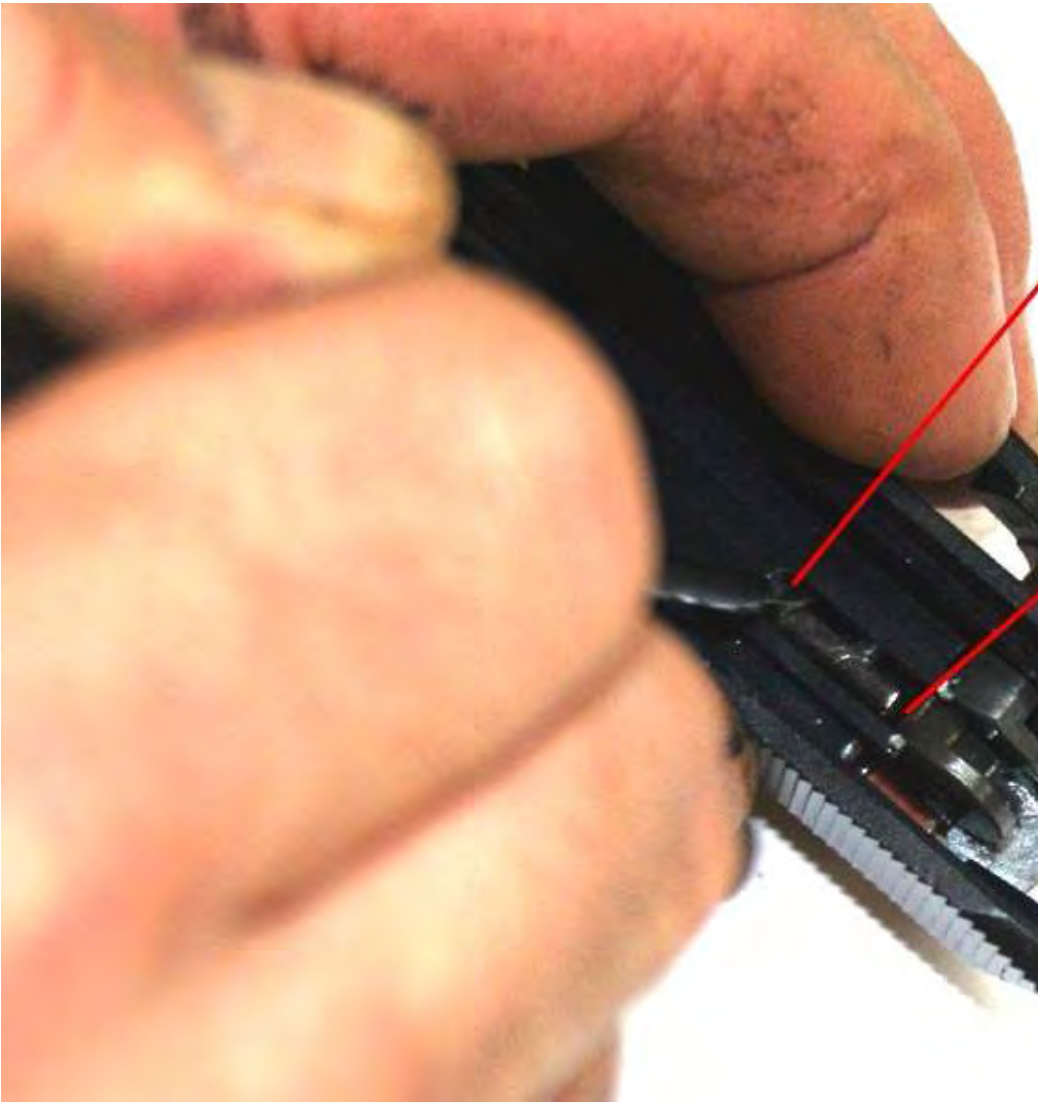

Holding firing pin back while pushing safety in

Release firing pin once you have captured the safety lever



Safety lever needs to be straight to finish the installation

Use a screwdriver to keep straight while compressing part

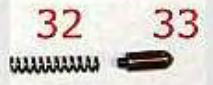

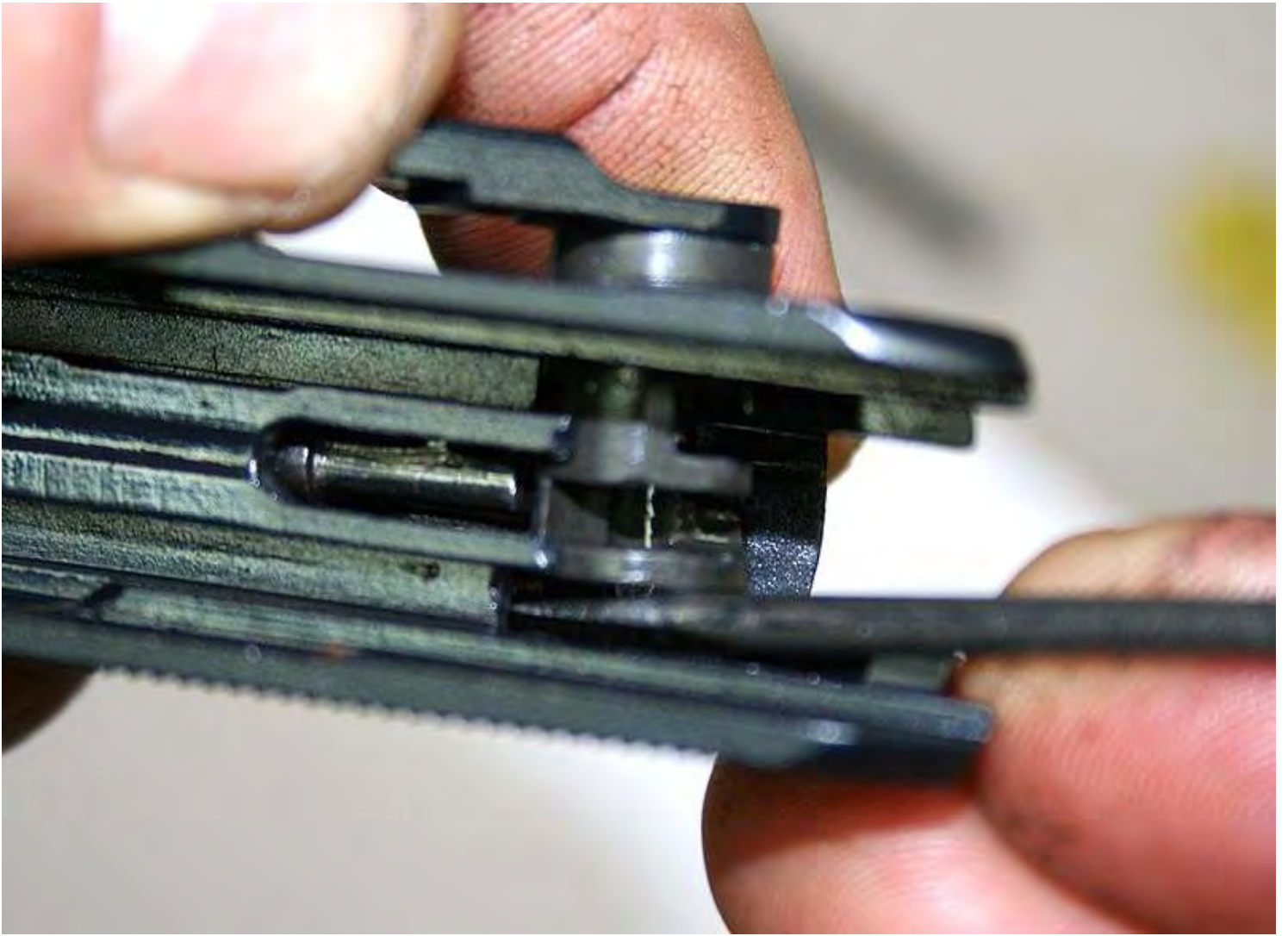



32 33

Part 31 & 32 are now captured by the edge of the safety lever and now the safety can be straightened with a screwdriver to allow further insertion of the lever into the slide. You will hear and feel the final insertion snap into place.

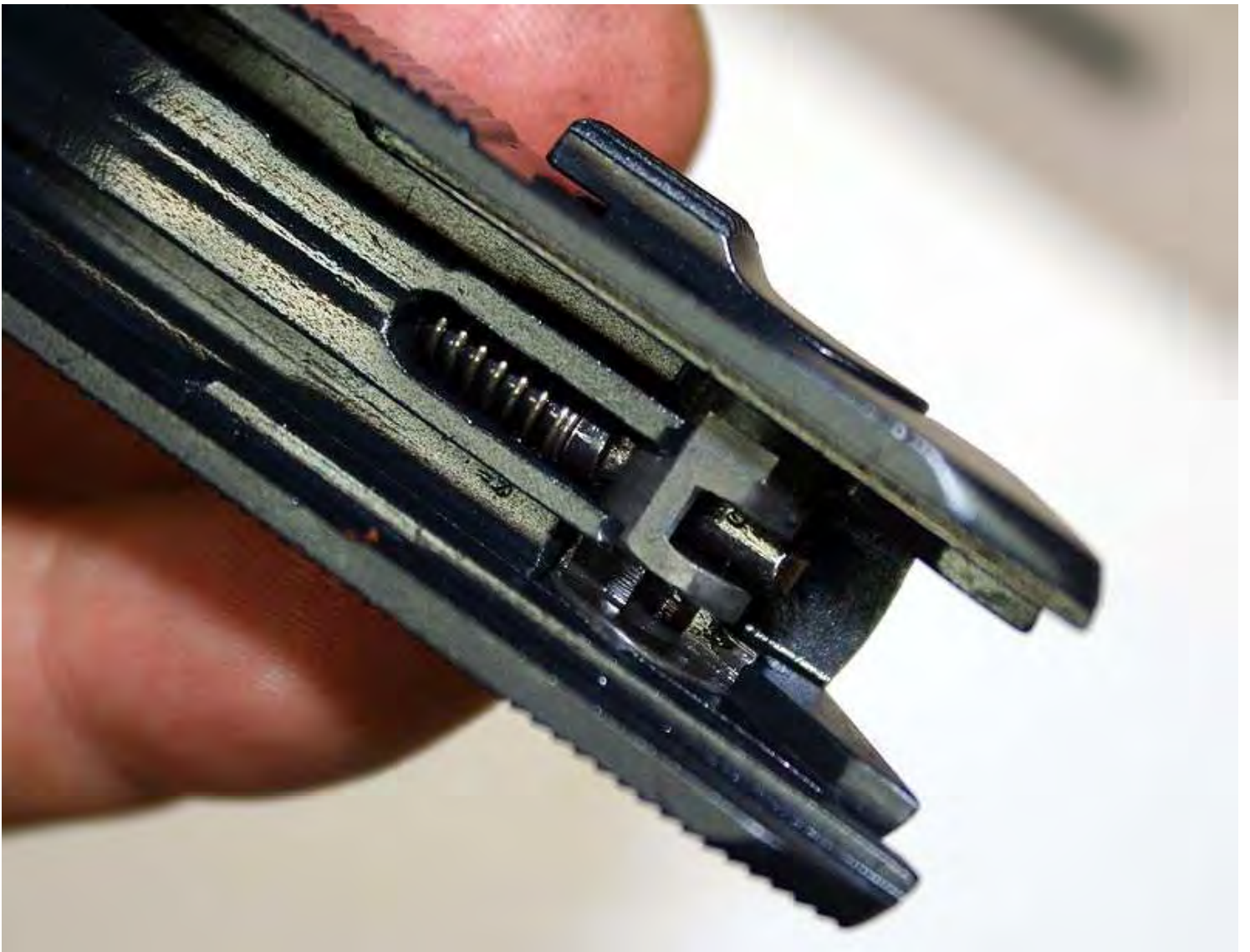

Step 3

25  26

 27





Make sure "recessed" area of part 25 is faced down

25 26

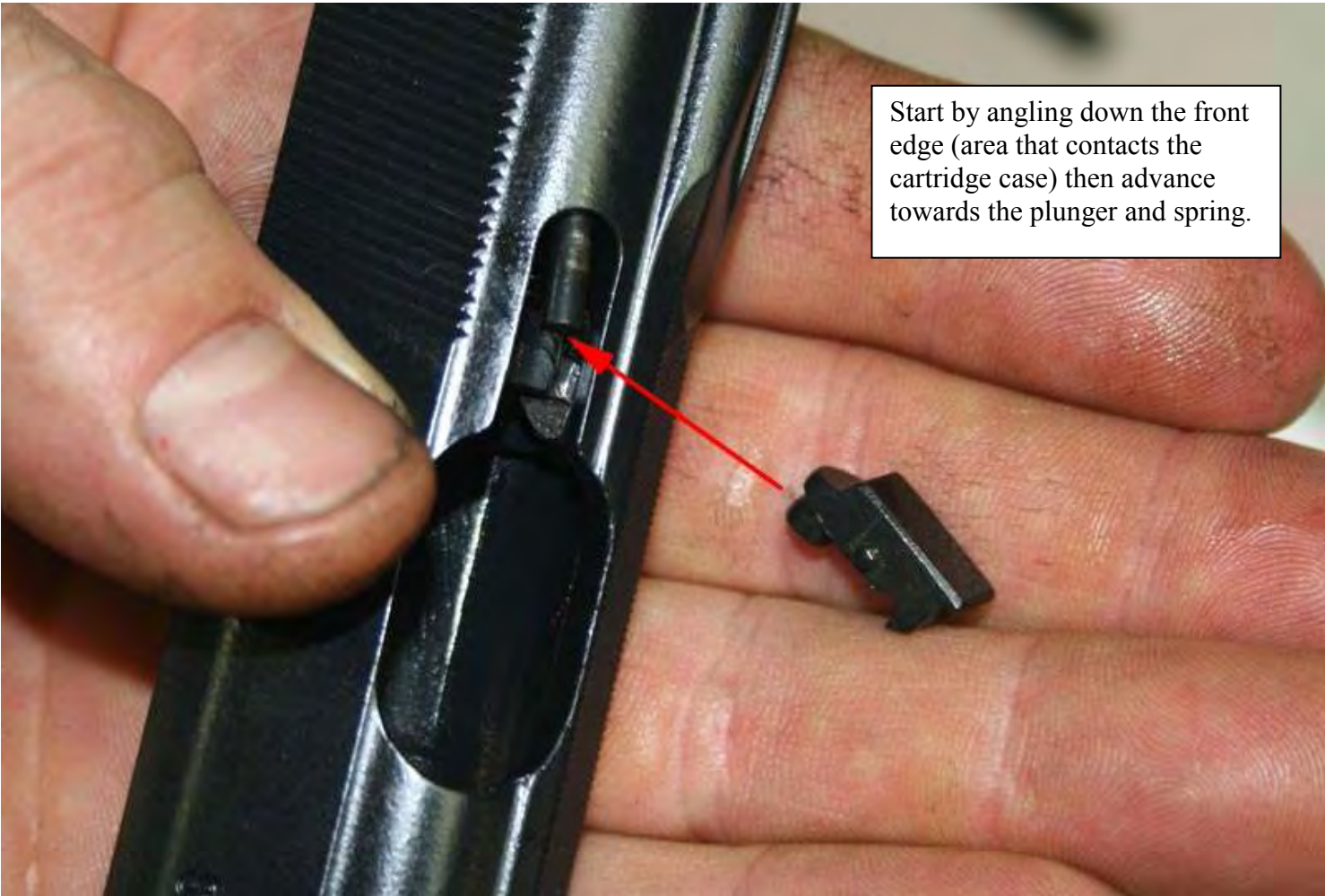

Start by angling down the front edge (area that contacts the cartridge case) then advance towards the plunger and spring.



Compress part

25  26

with small screwdriver



Be careful that screw driver blade does not pop out since your placing pressure hold it in and back to facilitate insertion of part 27 



Finished with slide



Step 4

Once part 14 & 15 are in place align trigger guard and compress upward till you can insert pin





Step 5



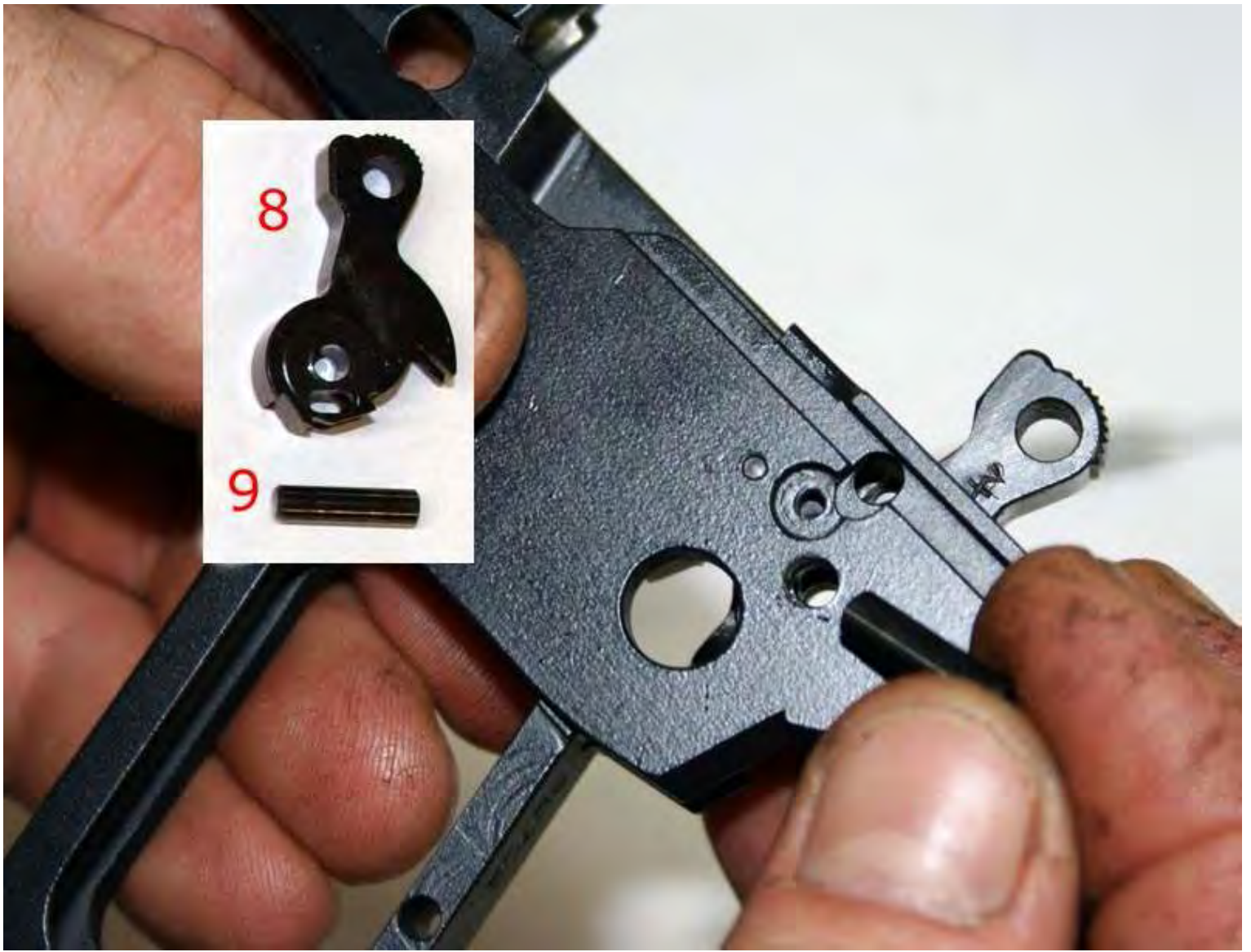



Step 6





Needle Nose
Pliers Help

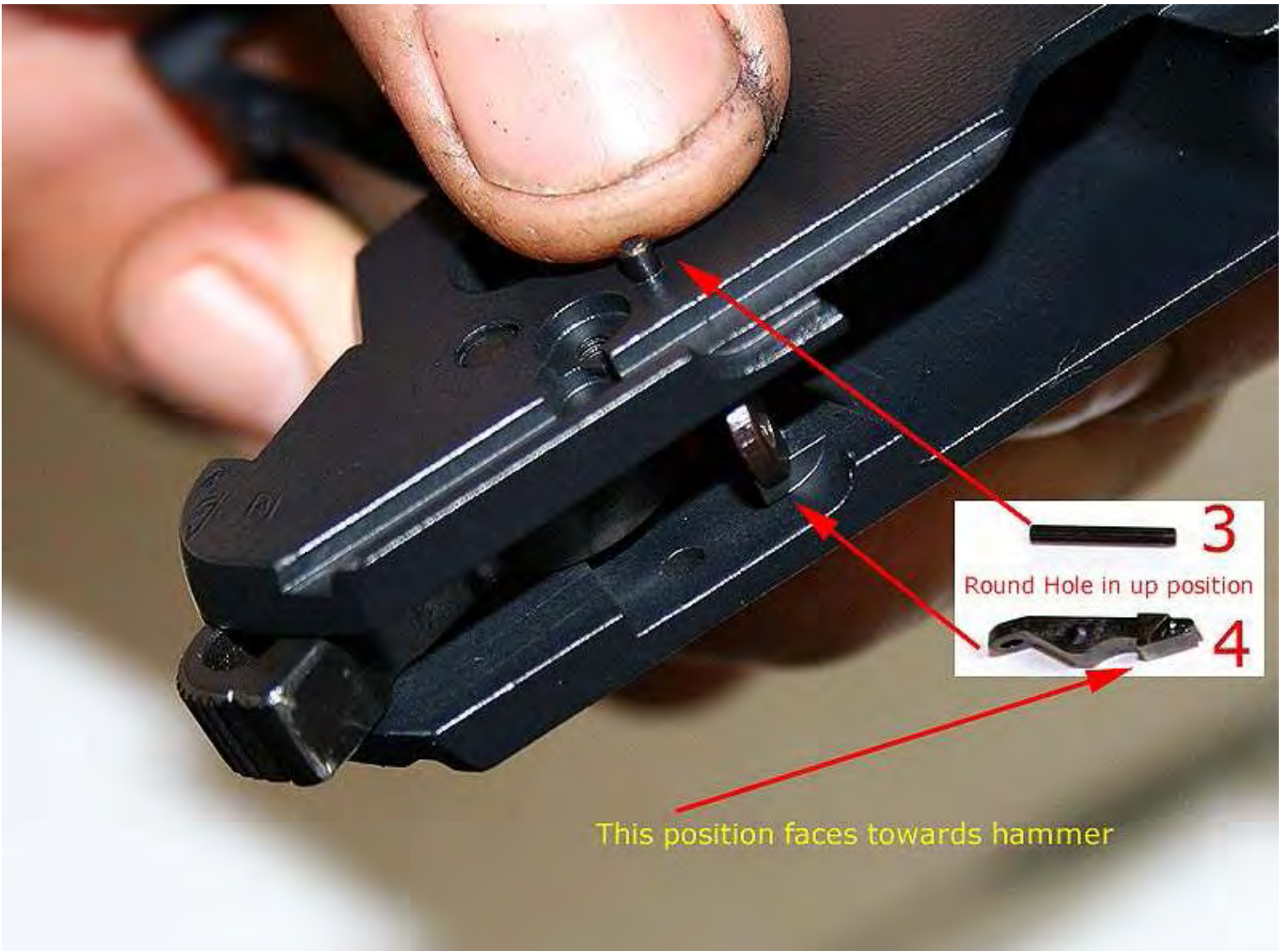

This position faces towards hammer

Part 7

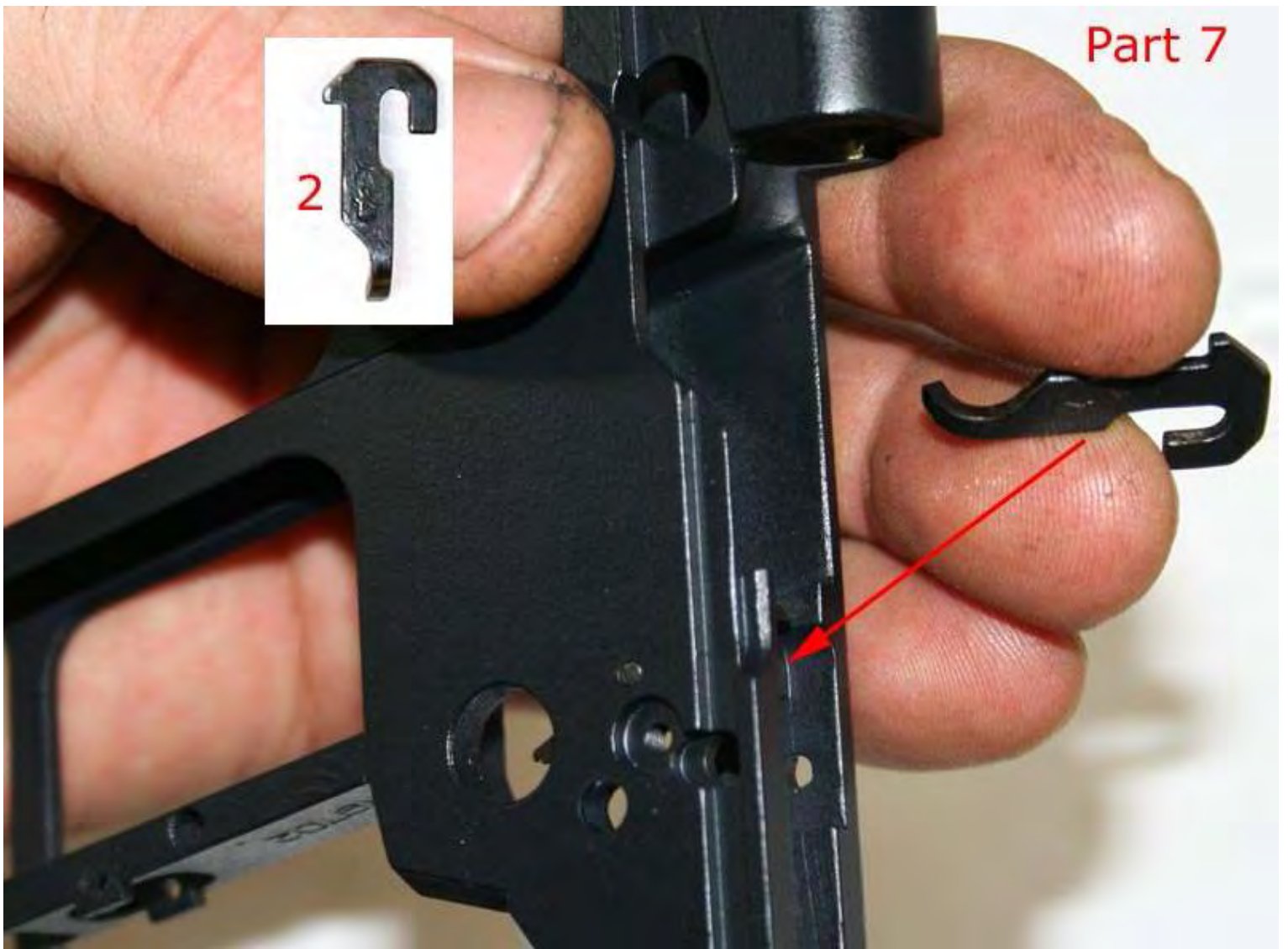

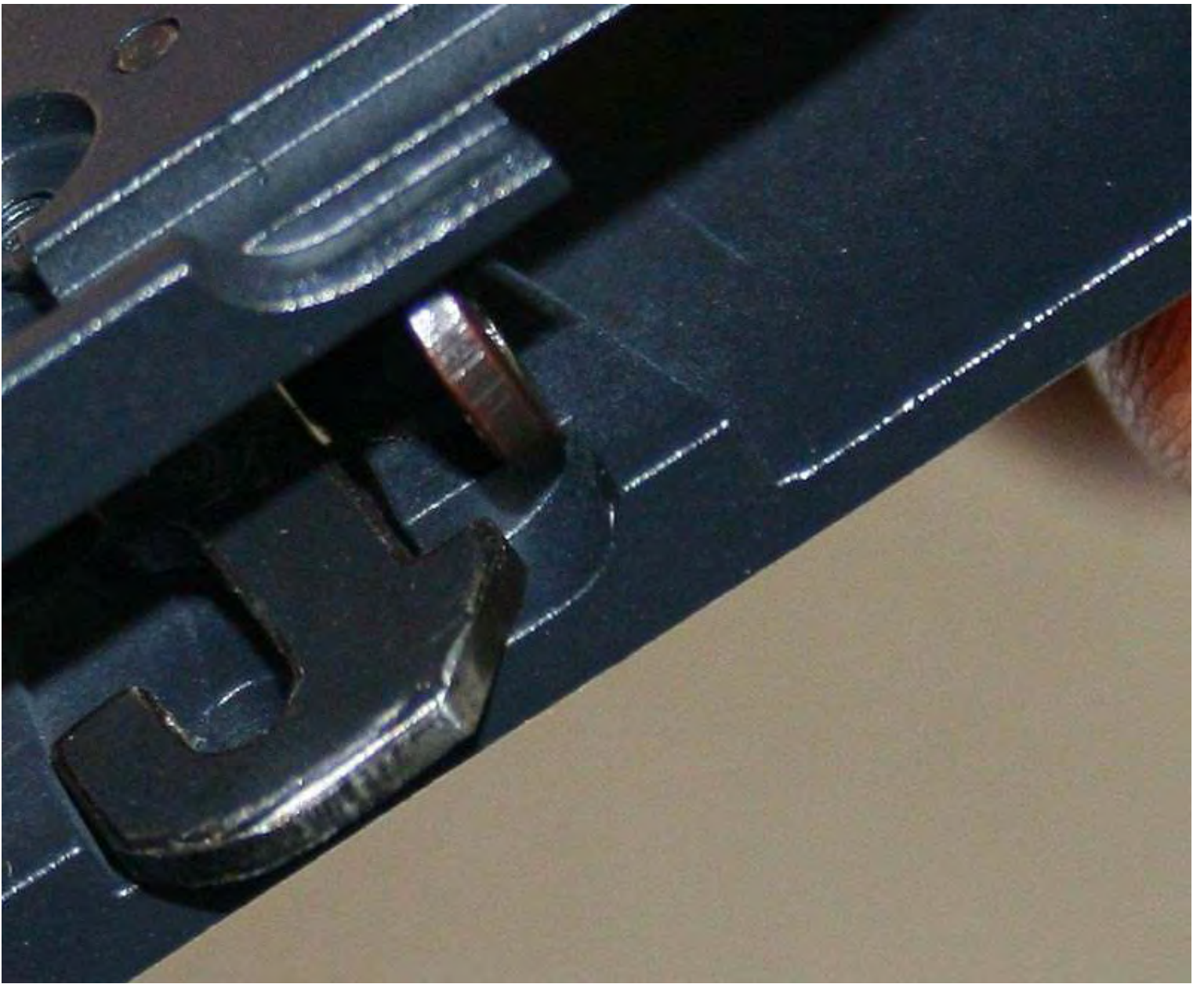

Step 8



Make sure the plunger post is to the left of the frame to allow it to align to the hole in the sear

Don't push pin all the way yet

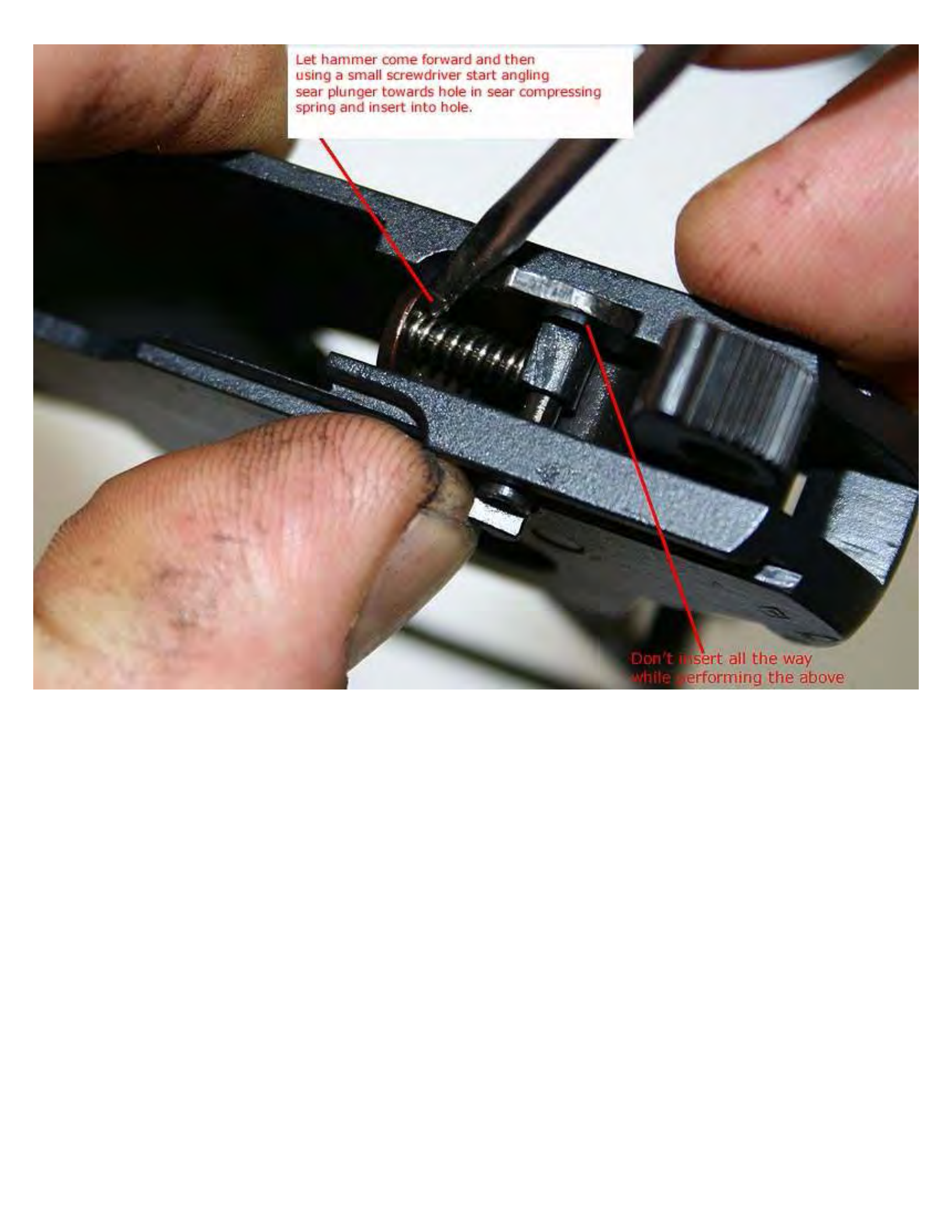

A close-up photograph of a mechanical assembly. A person's hands are visible, holding a metal tool (likely a screwdriver) and a metal component. The component has a hole and a spring. The screwdriver is being used to compress the spring. A hammer is also visible, having just struck the component. The background is a plain white surface.

Let hammer come forward and then using a small screwdriver start angling sear plunger towards hole in sear compressing spring and insert into hole.

Don't insert all the way while performing the above

Push pin all the way once the sear pin is in the hole of the sear.



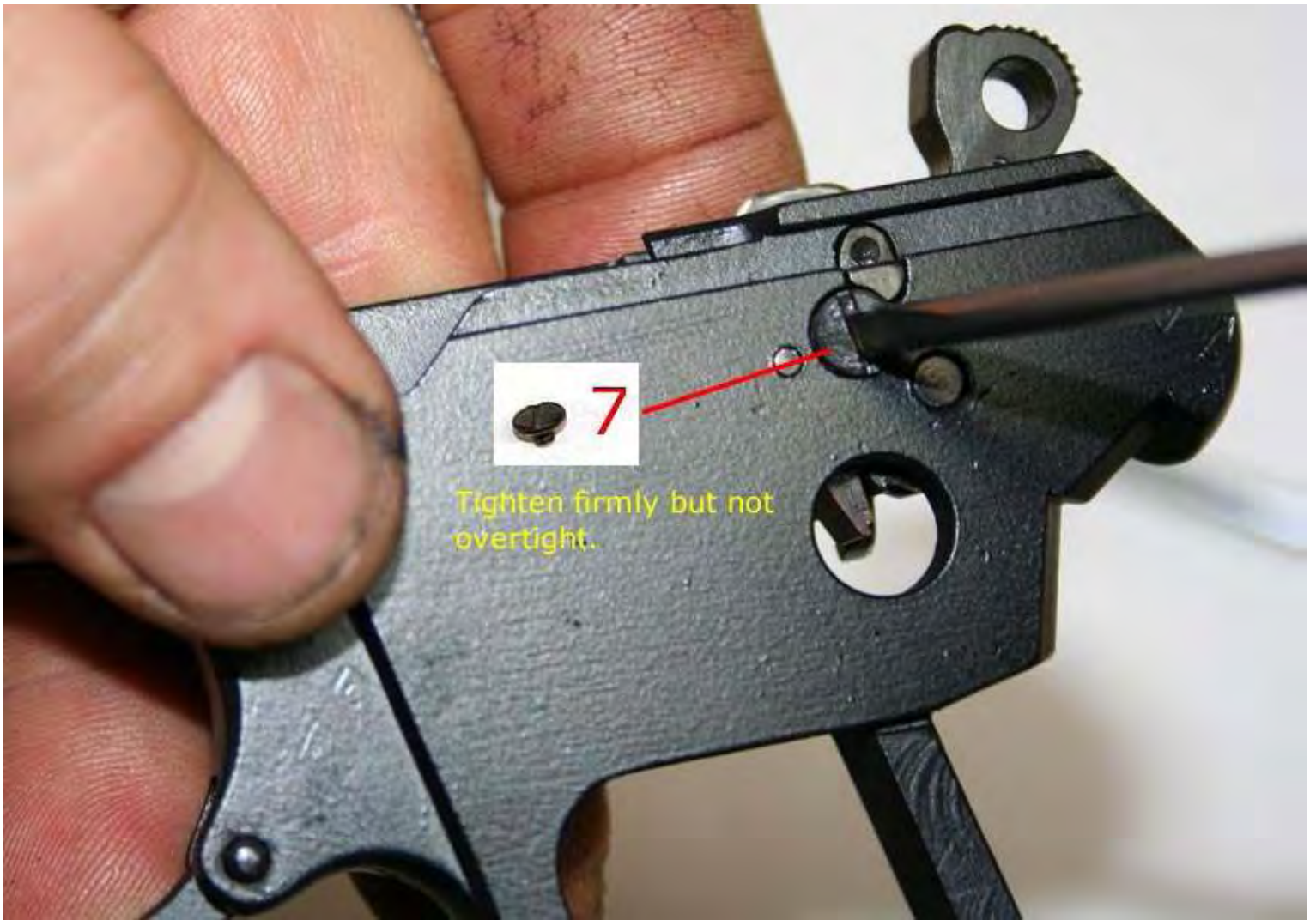

Tighten firmly but not overtight.

Step 9

11A

11

Norm has an alternate version of doing this step 9. I will post that variation at the end of this.

10

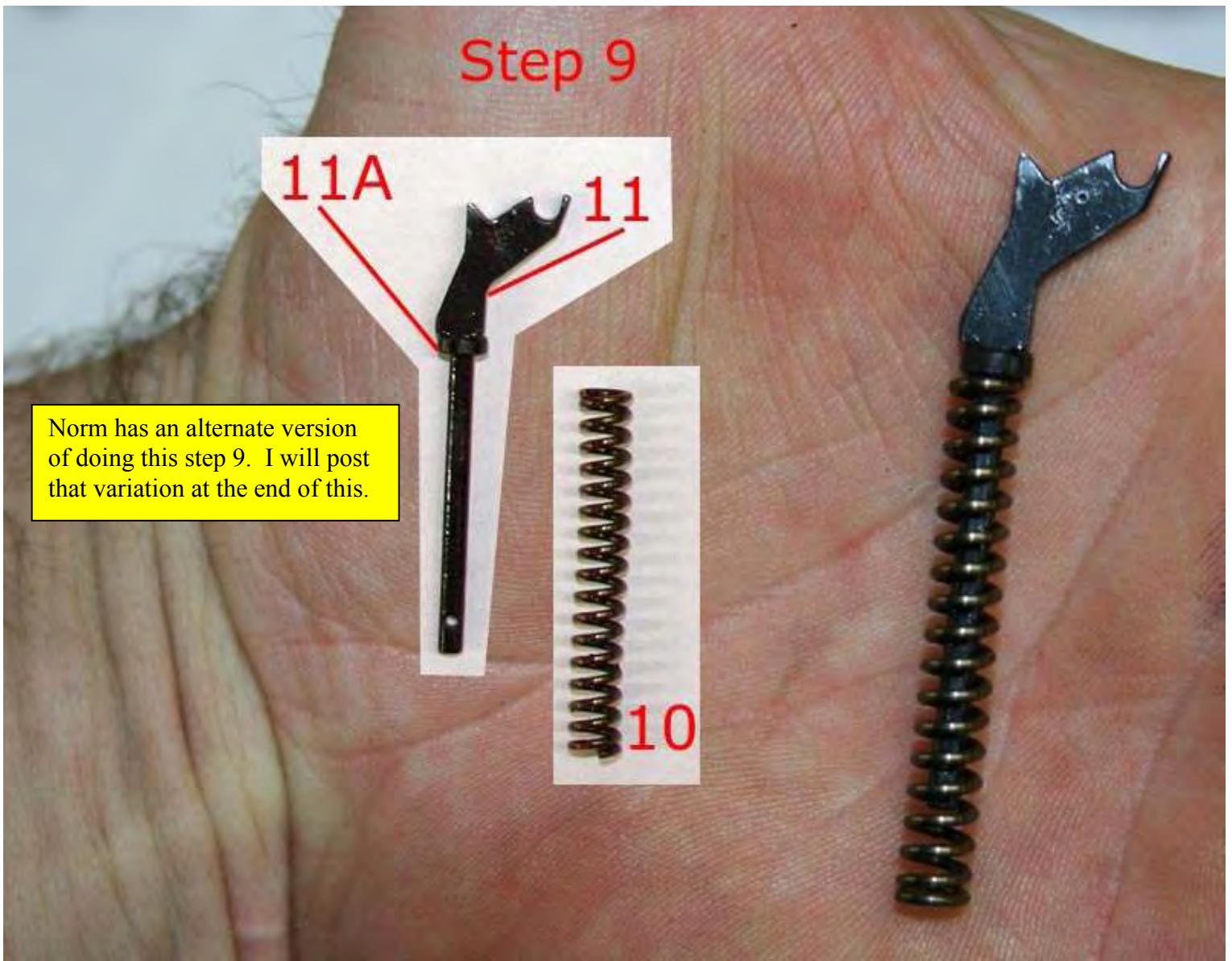

Place good gun
grease here before
placing on hammer
group





Make sure the angle is such that it looks like this and spring rests near frame like this

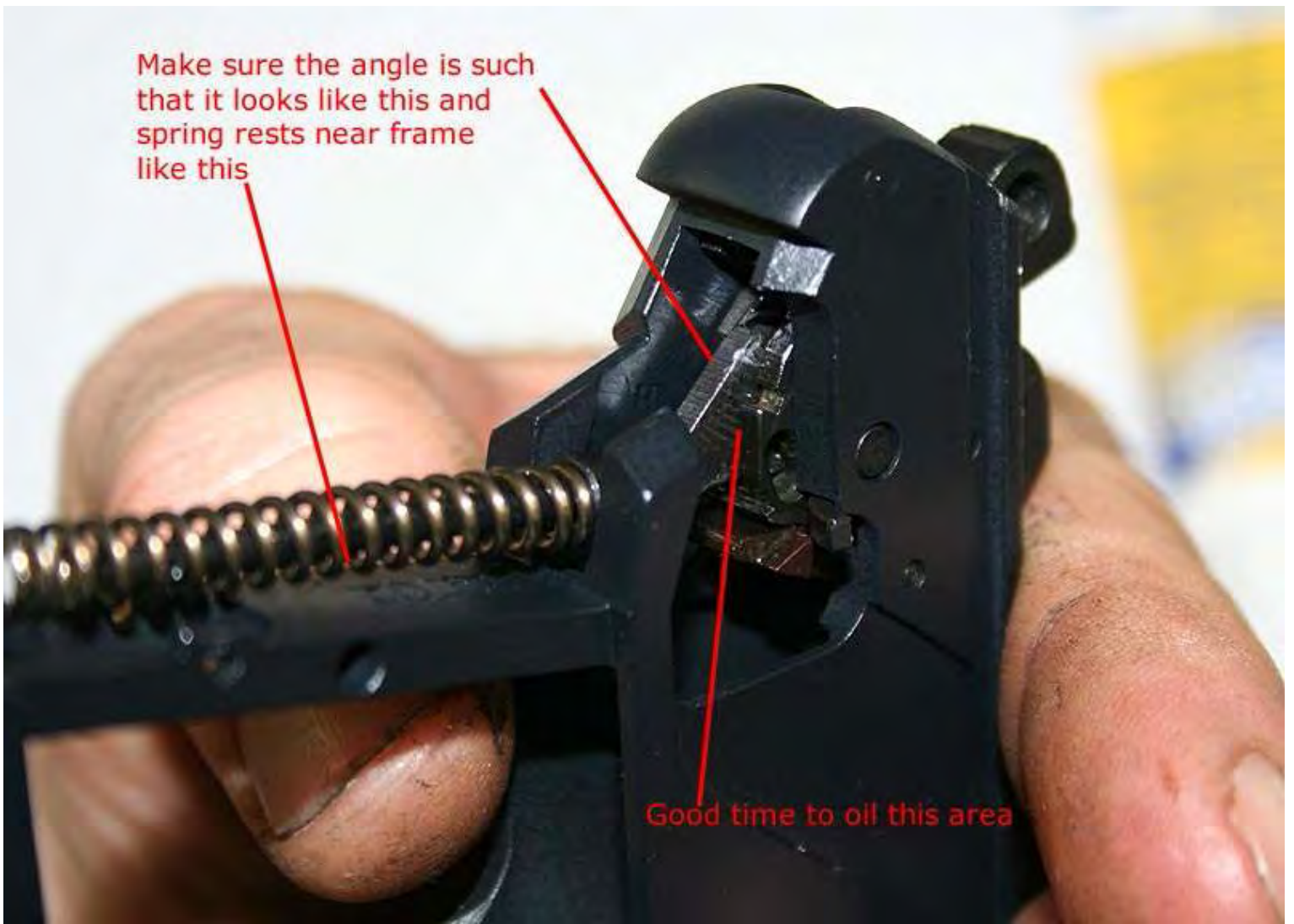

Good time to oil this area

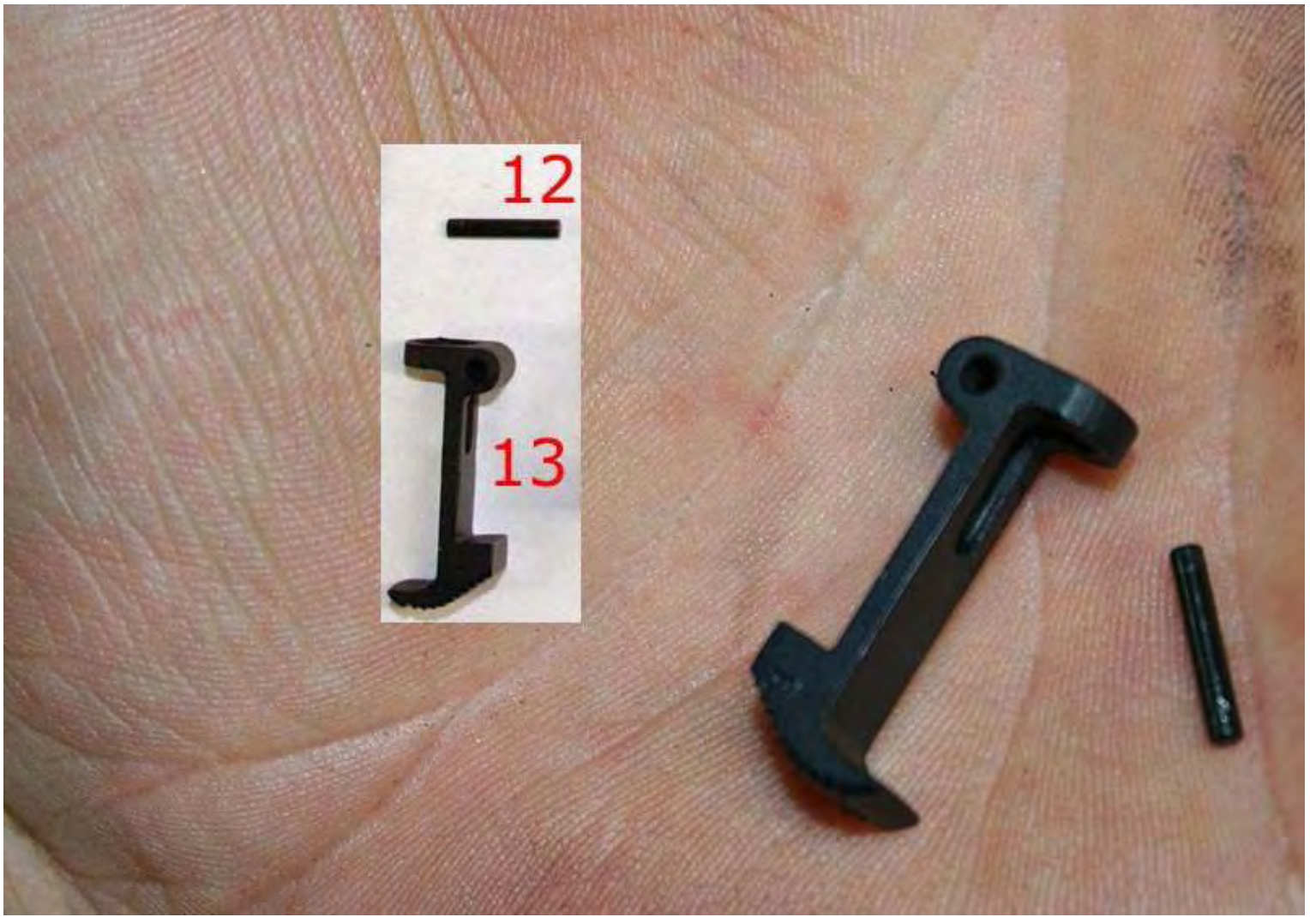

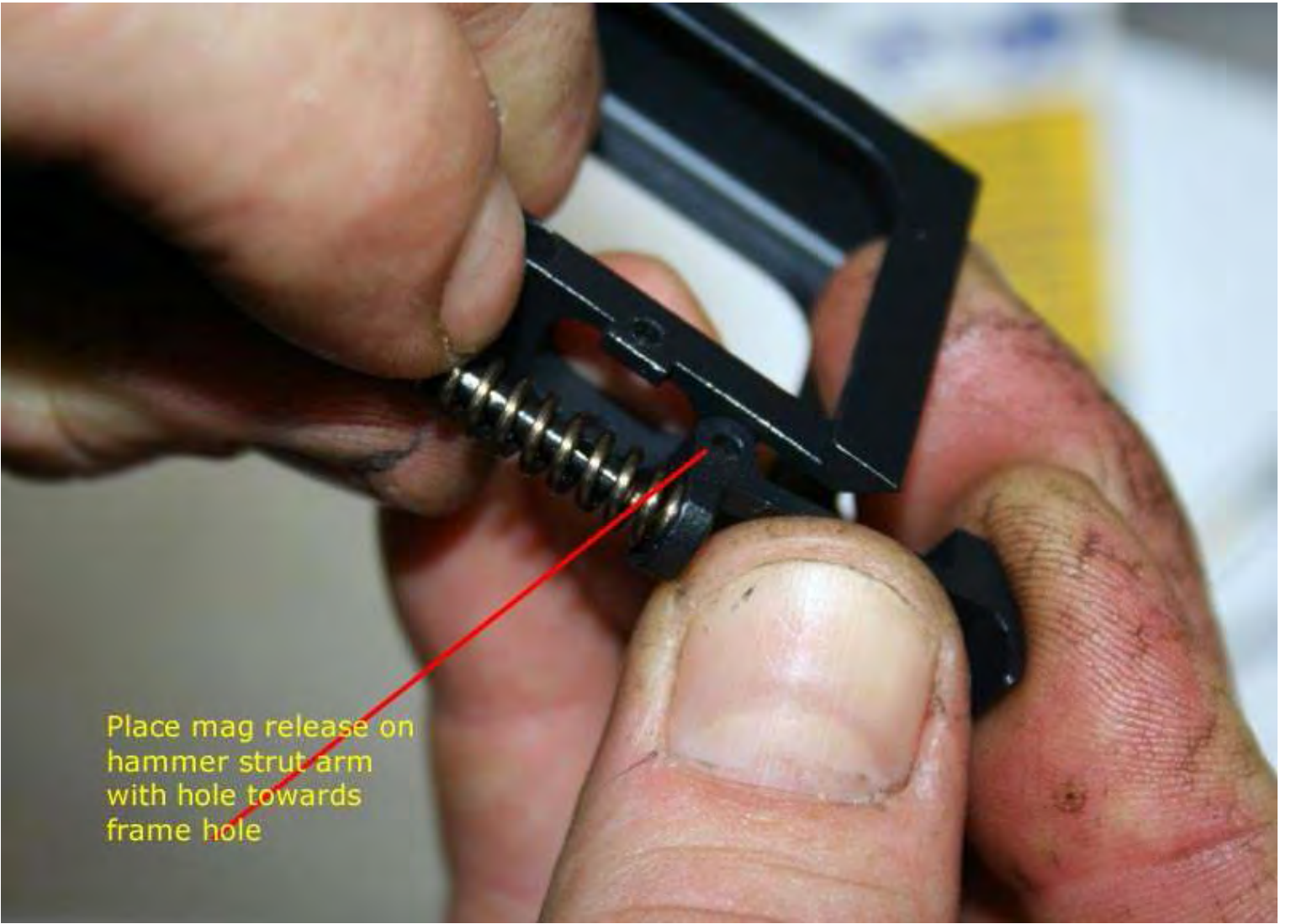

Place mag release on
hammer strut arm
with hole towards
frame hole

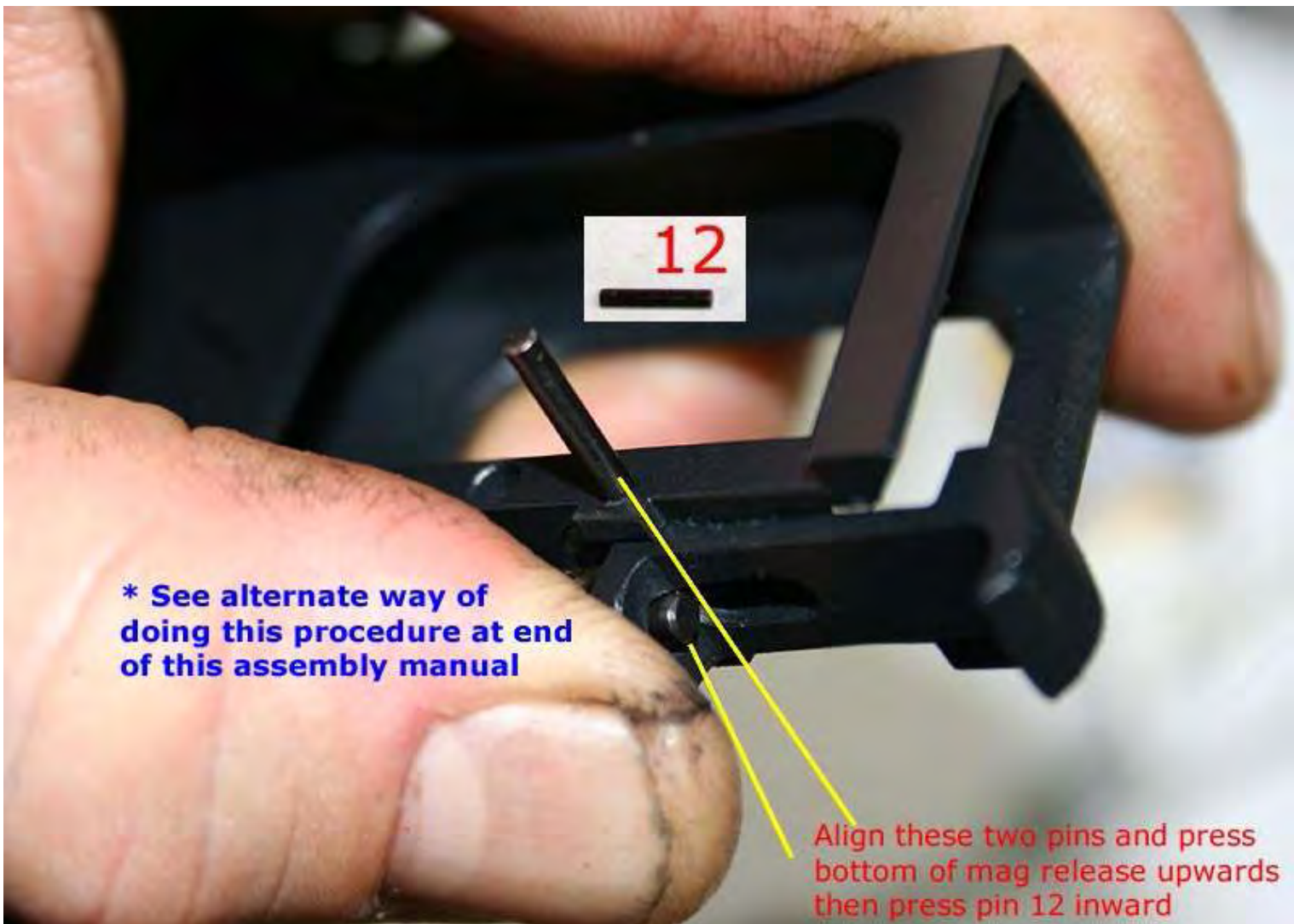

12

*** See alternate way of doing this procedure at end of this assembly manual**

Align these two pins and press bottom of mag release upwards then press pin 12 inward



Press pin inward flush with frame
you will have to wiggle the mag release part to
push pin all the way in

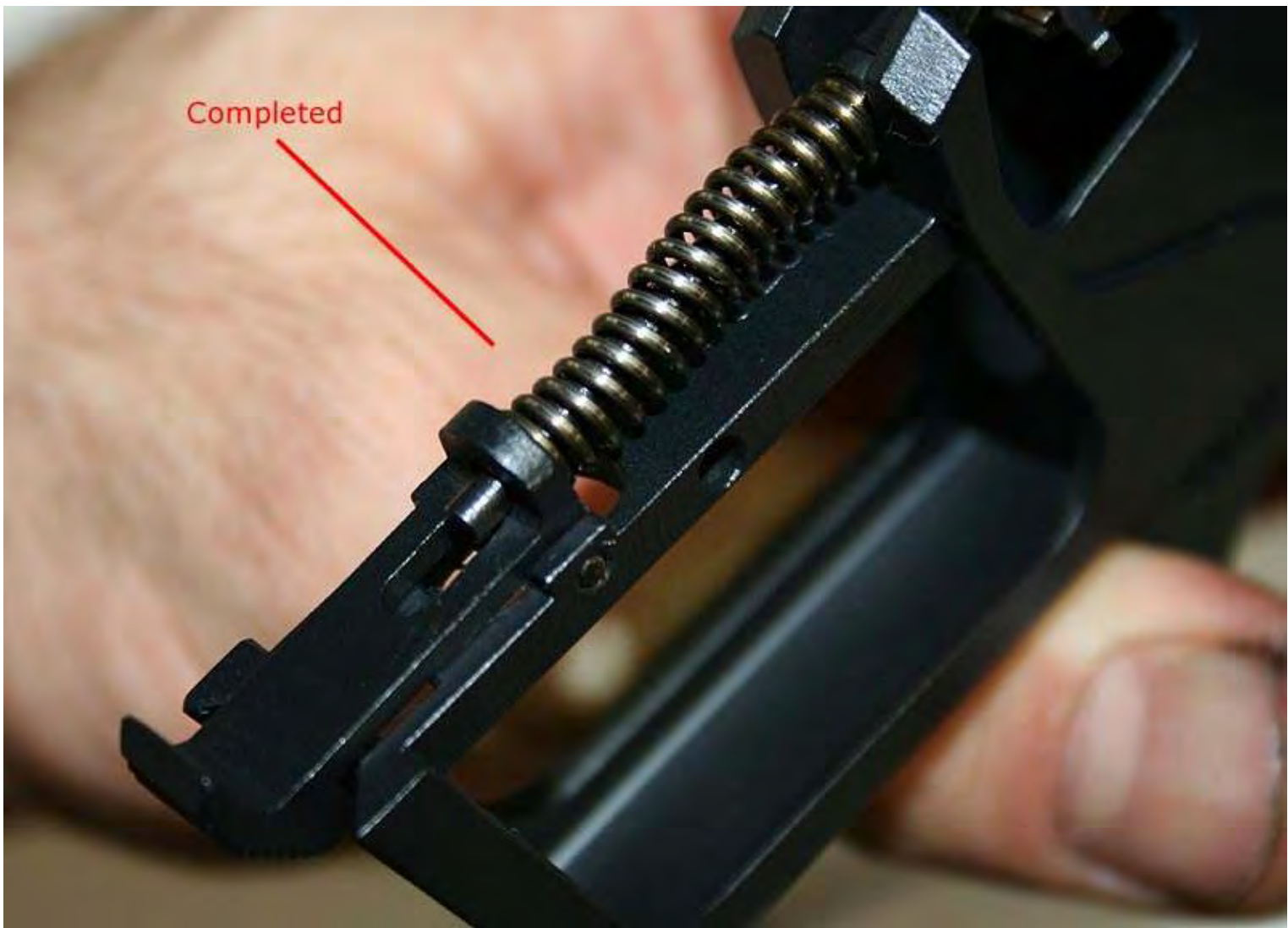

Completed

Step 10

Snip a piece of Q-tip to the exact width of trigger housing and insert with spring in this position.



Norm sells extra trigger springs that are superior.

The long part of the trigger spring is to the side of the trigger cam with hole in it





Align Q-tip with hole on both sides.
Pull trigger downward then push Q-tip
out with trigger pin taking its place.

Spring should be positioned this way

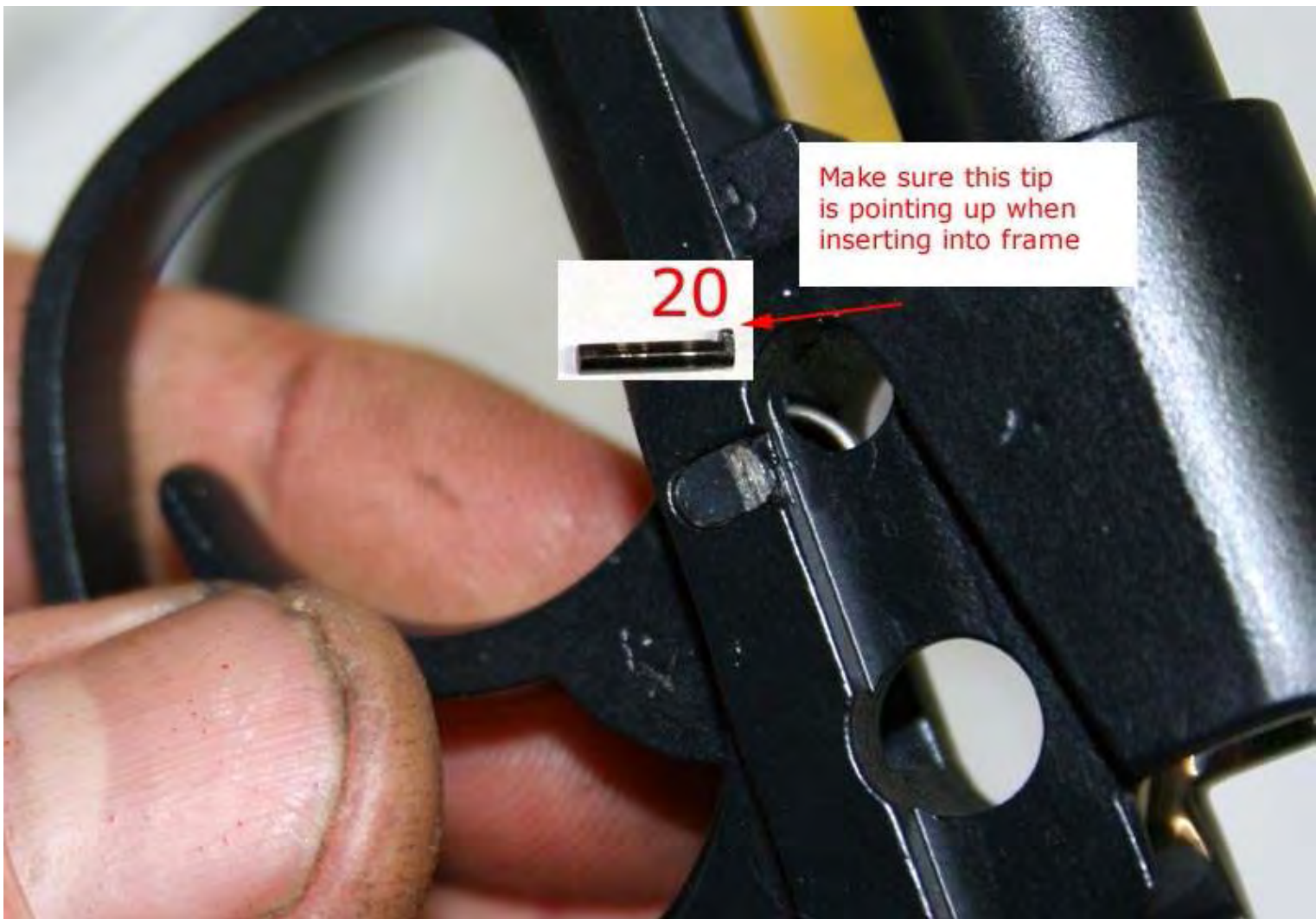

Step 11

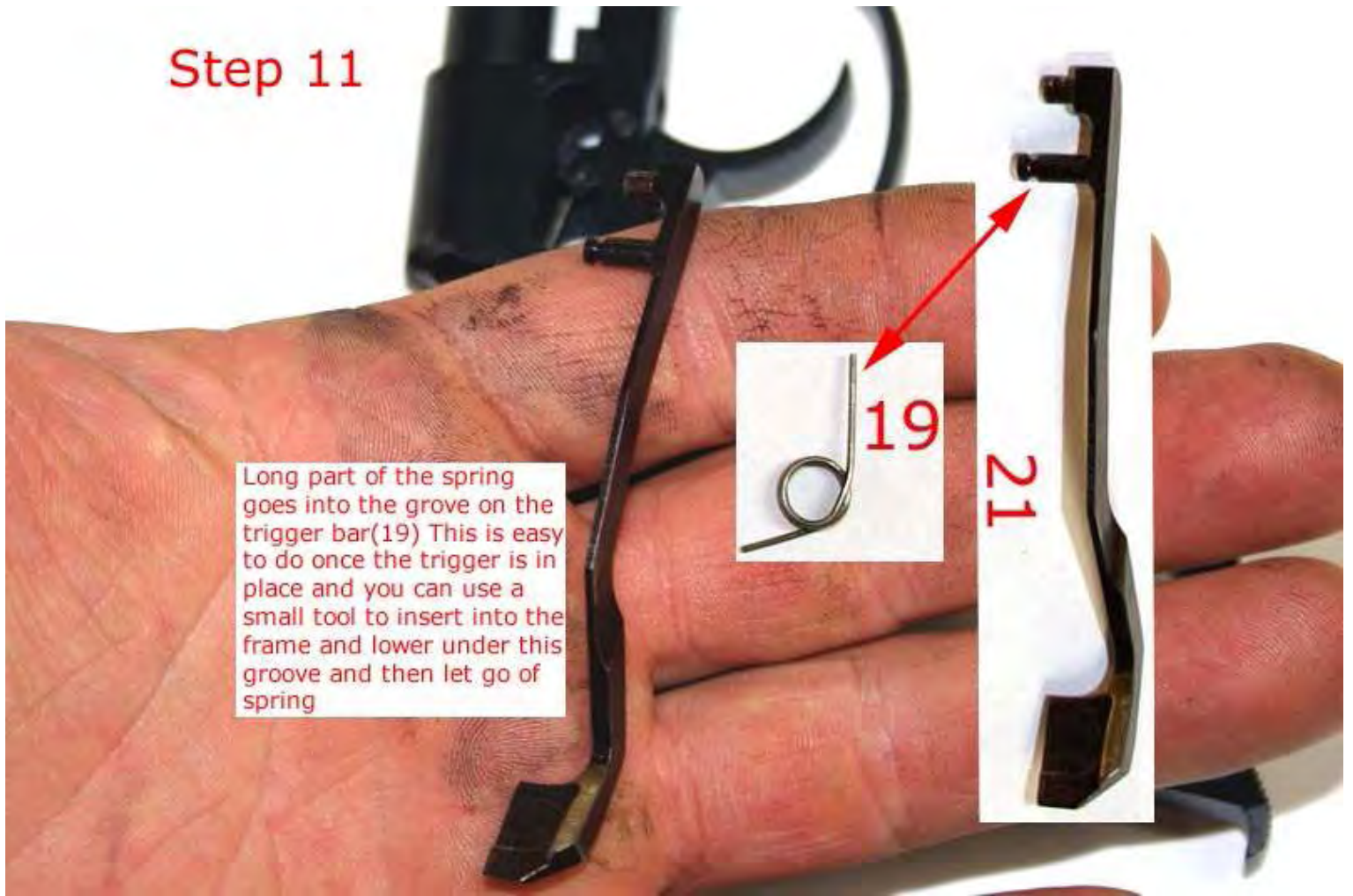

Insert small punch or mini screw driver to pull this spring arm towards you and then down below the groove on the trigger arm

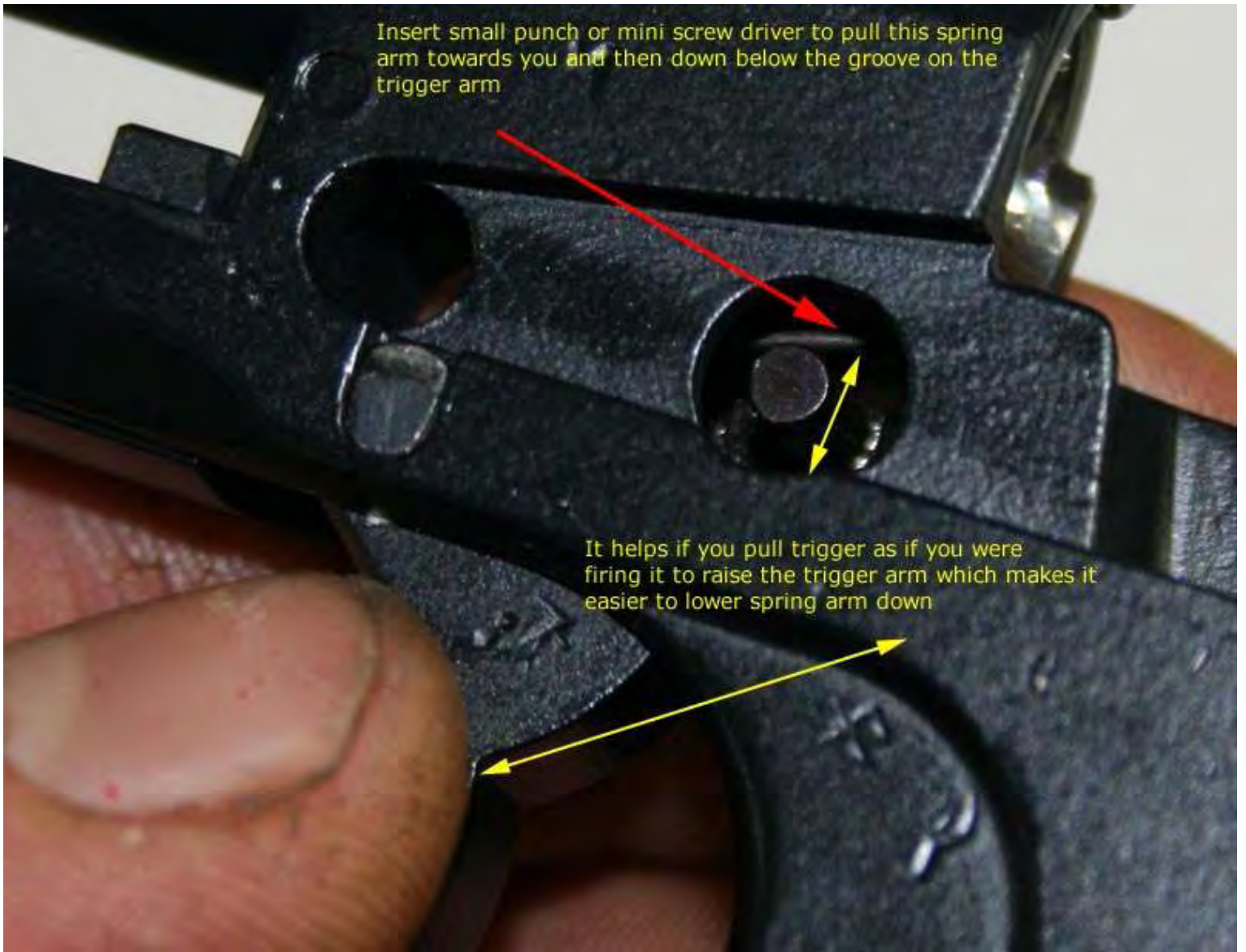

It helps if you pull trigger as if you were firing it to raise the trigger arm which makes it easier to lower spring arm down

This is where the spring should be when you let go and it will rest in the groove. Make sure you keep the trigger bar on the other side stays tight to the frame and trigger or the spring will pop off the trigger arm and you will have to start over.



Step 12

Norm sells extra slide lock springs that are tough.





Lay slide stop like this. Move towards the right to capture the spring under the groove & then slide to the left.



Slide stop spring is in position...
Now move to the left where it
will stay







Don't over tighten the grips as sometimes they can crack if too tight.



Make sure the small end of recoil spring fits tightly over barrel by the chamber



Good to put some grease or lube here.



Cock the hammer, pull trigger guard down
feed the slide over barrel and push all the way back
then when slide is all the way back then push down till
the slide rails match the frame rails. Allow the slide to go
forward then place trigger guard back in place and your done.



Good luck... Of course there are variations to the assembly and disassembly. This is what I found is fairly easy. You may find something that works better for you. I will post a few variations given to me by another board member (Norm)

Good luck,
Troy Harp





This tip/method was told to me by Norm Sutton.

This is an alternate (effective) way to facilitate spring removal/replacement or assembly. Remove grips, cock hammer get paper clip ready and now go to next photo....



Cocking the hammer back will expose the hole at the bottom of the "hammer strut". You then push a paper clip in the hole. Go to next photo...

Hold paperclip in place then squeeze trigger
Ride the hammer down and don't release it,
hold it against the safety catch without
releasing it. Then you will be able to
push the spring pin out easily.





Again hold the hammer to the safety catch and then push out the spring pin here.

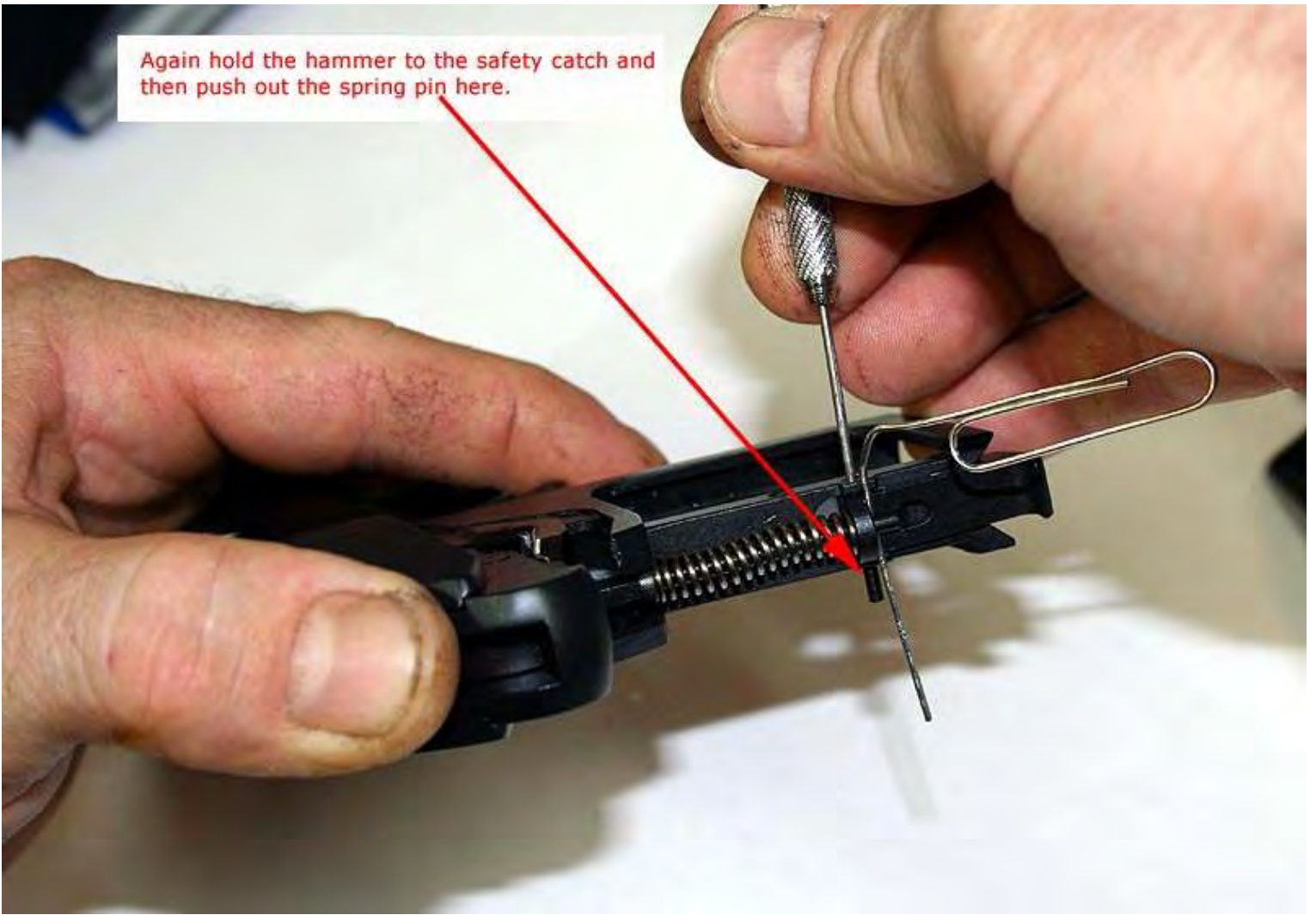

Now release the hammer and the hammer strut and spring and mag release will come out as a package.



Use a vise or vise Grips (padded) to hold the hammer strut (on the flat sides) then press down on mag release part to compress spring and then pull out paper clip.





Now reverse the procedure to put it back together. You can use a vice or vise-grips on the mag release to push the spring back on the hammer strut rod.

